

The first Thread Rolling Screw to provide you with 360° thread engagement

Eliminate Drive to Strip ratio problems & retain more of your initial tightening torque when compared to tri-lobular type screws

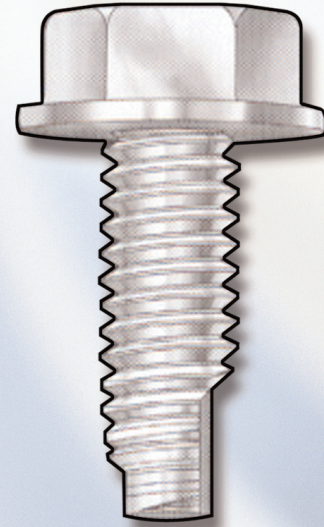

The Benefits of the Tap/R Thread Rolling Screw include

- Reusability in the same hole without cross threading. The unique tapered intermittent thread form allows the Tap/R to be removed and reused in the same hole, time after time, without damaging the mating thread.
- Reduces driving torque while increasing stripping torque.
- Rapidly locates pilot holes due to the unthreaded relief areas.
- Removes paint and porcelain from pilot holes. The relief areas on the shank also function as a paint scraper.
- Reliable, consistent performance perfect for automated assembly

ITW Shakeproof an innovator in the fastener industry for over 80 years is the first to manufacture a Thread Rolling Screw that provides you with 360° thread engagement for maximum holding power.

The unique thread configuration on the Tap/R begins as a tapered, intermittent thread and increases to a full 360° thread form. The mating thread is formed gradually and intermittently with minimal driving torque.

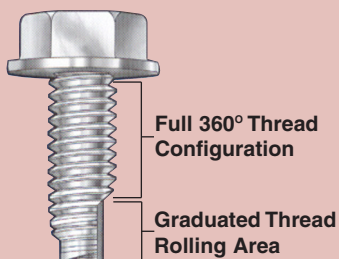

RECOMMENDED PILOT HOLE SIZES - INCH SCREWS (metric sizes also available)

Material Thickness	Inch	.020-.055	.061-.122	.125-.245	.250-.312	.313-.500	.375-.499	.500-.625
	Approx. U.S. Gauge	26-17	16-11	11-3	3-5/16"	5/16"-1/2"	3/8"-1-2"	1/2"-5/8"
Inch Nominal Screw Size DIA.-T.P.I.	Material	Pilot Hole Diameter	Pilot Hole Diameter	Pilot Hole Diameter	Pilot Hole Diameter	Pilot Hole Diameter	Pilot Hole Diameter	Pilot Hole Diameter
4-40	STEEL	.098	.102	.104				
	ALUMINUM	.098	.100	.102				
6-32	STEEL	.120	.120	.125	.128			
	ALUMINUM	.120	.120	.125	.125			
8-32	STEEL		.147	.150	.154			
	ALUMINUM		.147	.150	.152			
10-24	STEEL		.166	.172	.177			
	ALUMINUM		.166	.166	.170			
10-32	STEEL		.173	.177	.180			
	ALUMINUM		.173	.173	.177			
12-24	STEEL		.193	.199	.203	.203		
	ALUMINUM		.191	.196	.199	.203		
1/4-20	STEEL		.219	.224	.228	.234		
	ALUMINUM		.219	.221	.224	.228		
5/16-18	STEEL			.281	.285	.285	.290	
3/8-16	STEEL				.348	.348	.354	.354

POINT STYLES

TAP/R® screws are available with either a semi-gimlet or blunt point.

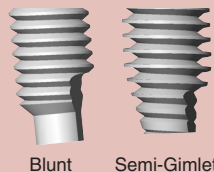

HEAD STYLES

TAP/R® screws are available in all conventional head styles and meet ANSI/ASME standards

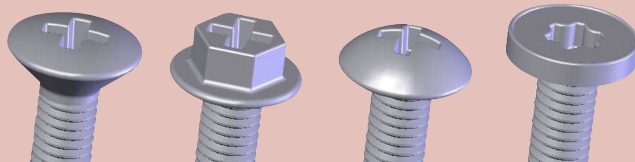

ITW Shakeproof

An Illinois Tool Works Company

2550 S. 27th Ave.

Broadview, IL 60155

Phone: (708) 681-3891

Fax: (708) 681-3690

Web: www.Shakeproof.com

Email: sales@itwsp.com